

SET-UP STEPS

SAFETY HUBER NEEDLE COMPATIBLE WITH PRESSURE INJECTIONS

PPS **CT**



- Disinfect the puncture area according to the hospital protocol.
- Select the gauge according to the viscosity of the drug to be infused and the desired flow rate.
- Choose the length of the needle according to the port size and thickness of subcutaneous tissue.



Before use, always prime the needle and the extension line with saline solution.



Remove the protective cover from the needle.

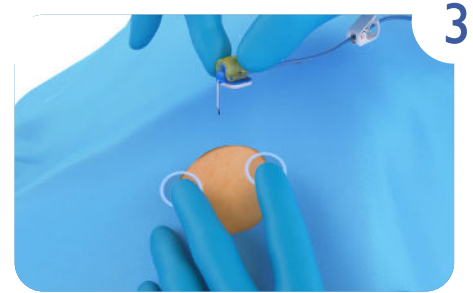

Locate and hold the port with your fingers. Hold the needle by the extractor. Puncture the port septum through the skin. The needle must be perpendicular to the skin.

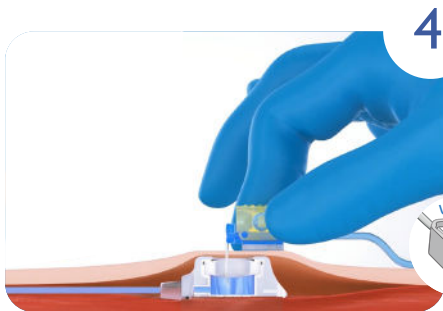

You should be able to feel the bottom of the reservoir with the tip of the needle. Once you feel the bottom of the reservoir, stop in order to avoid crushing the needle tip.



Before infusion, check blood reflux for patency.



Flush the line by using a push-pause flushing technique to increase flushing efficiency.



A foam cube is provided with the needle. Place it under the piston to ensure stability and patient comfort.



It is recommended to use adhesive strips to increase needle stabilisation. Apply one to the head of the needle and two in a cross pattern over the piston.

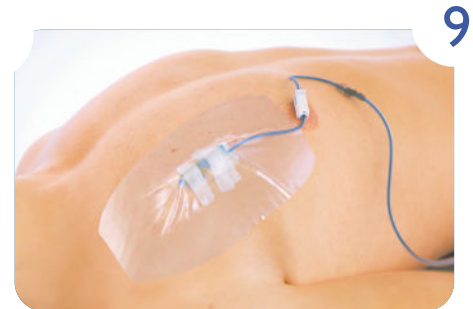

Apply a transparent occlusive dressing over the needle to protect and monitor the puncture site.

