

# Directions for Use

Using 100% Oxygen

**IMPORTANT:** AFTER EACH USE PLEASE ENSURE ALL COMPONENTS ARE PRESENT IN THIS CASE BEFORE IT IS PUT AWAY.

Set-up  
in less than  
2 minutes

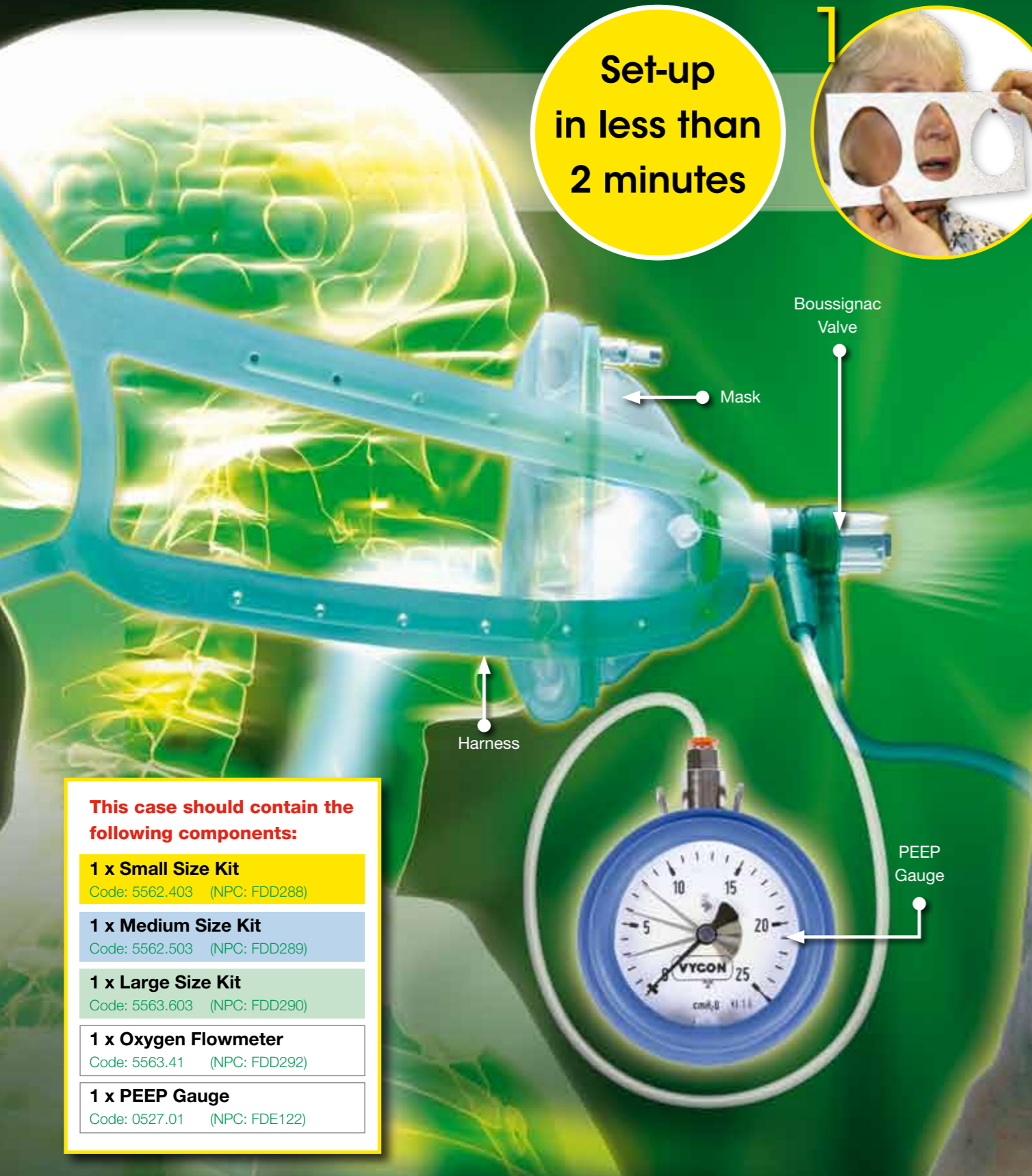
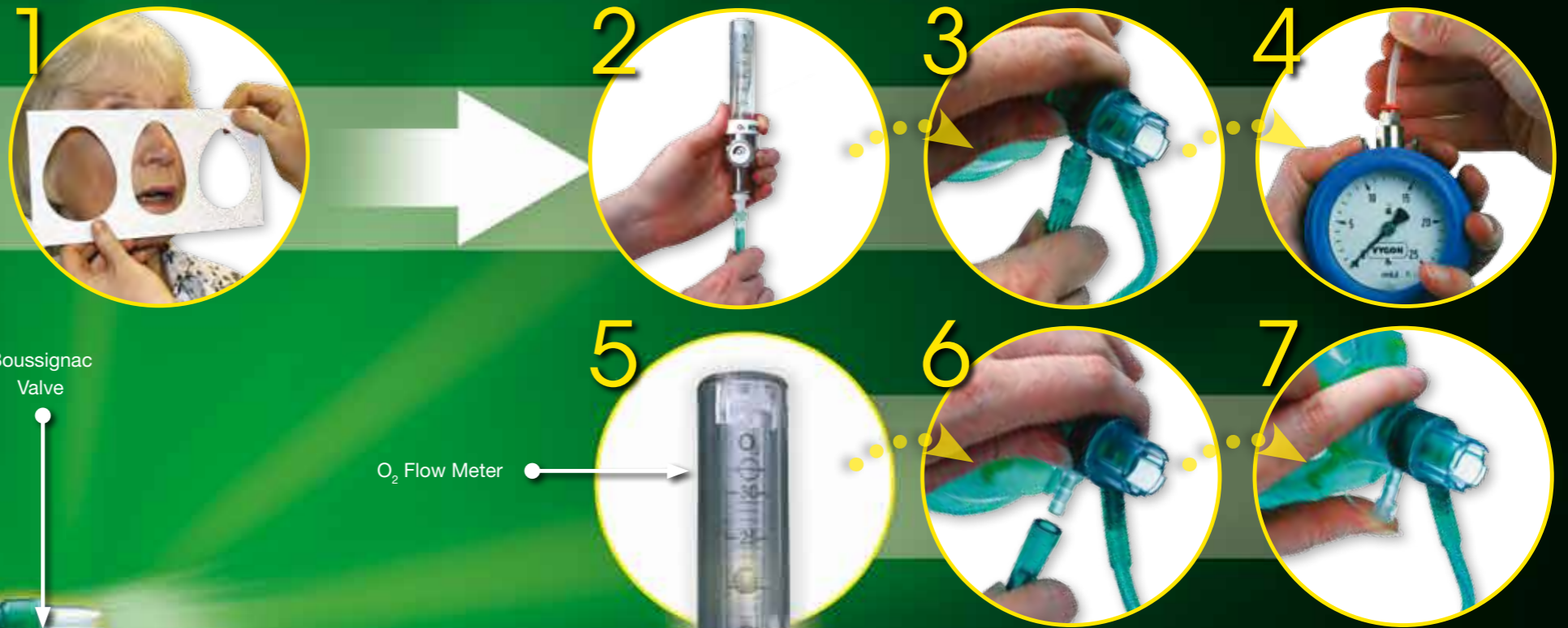

1. Select the appropriate size of mask kit. Attach the Boussignac valve to the mask\*.
2. Connect main line tubing to 30L/min oxygen flowmeter.
3. Attach PEEP gauge tubing to secondary port.
4. Attach narrow tubing into PEEP gauge.
5. With mask fitted to the patient adjust the oxygen flow rate to obtain the desired PEEP level using the CPAP pressure chart below.
6. Disconnect PEEP gauge tubing.
7. Re-cap port.

- This case should contain the following components:**
- 1 x Small Size Kit**  
Code: 5562.403 (NPC: FDD288)
  - 1 x Medium Size Kit**  
Code: 5562.503 (NPC: FDD289)
  - 1 x Large Size Kit**  
Code: 5563.603 (NPC: FDD290)
  - 1 x Oxygen Flowmeter**  
Code: 5563.41 (NPC: FDD292)
  - 1 x PEEP Gauge**  
Code: 0527.01 (NPC: FDE122)

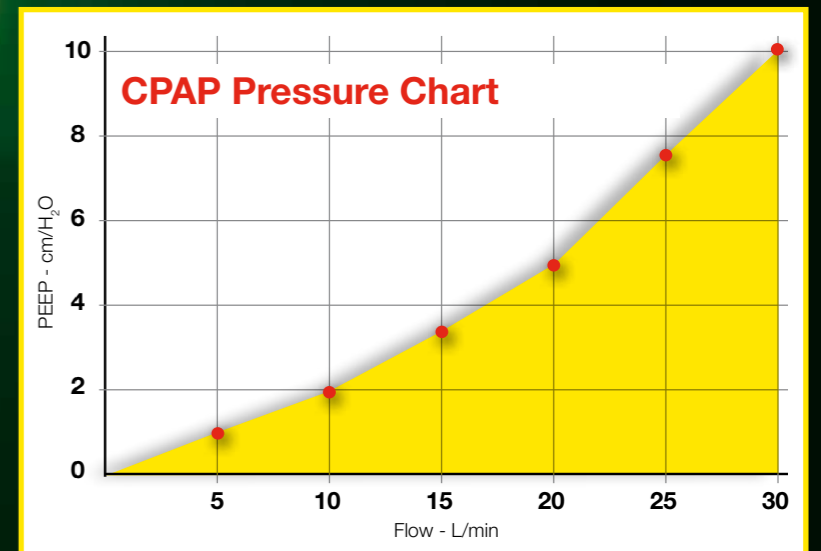

\* The Boussignac valve can also be used on endotracheal tubes and tracheostomy tubes.